

300 000 m 310 000 m 320 000 m 330 000 m 340 000 m 350 000 m 360 000 m 370 000 m

88° 50' 1 88° 45' 2 88° 40' 3 88° 35' 4 88° 30' 5 88° 25' 6 88° 15' 7 88° 05'

ALCORN COUNTY STREET INDEX

CO 001	AL 84,86	CO 002	CO 003	CO 004	CO 005	CO 006	CO 007	CO 008	CO 009	CO 010	CO 011	CO 012	CO 013	CO 014	CO 015	CO 016	CO 017	CO 018	CO 019	CO 020	CO 021	CO 022	CO 023	CO 024	CO 025	CO 026	CO 027	CO 028	CO 029	CO 030	CO 031	CO 032	CO 033	CO 034	CO 035	CO 036	CO 037	CO 038	CO 039	CO 040	CO 041	CO 042	CO 043	CO 044	CO 045	CO 046	CO 047	CO 048	CO 049	CO 050	CO 051	CO 052	CO 053	CO 054	CO 055	CO 056	CO 057	CO 058	CO 059	CO 060	CO 061	CO 062	CO 063	CO 064	CO 065	CO 066	CO 067	CO 068	CO 069	CO 070	CO 071	CO 072	CO 073	CO 074	CO 075	CO 076	CO 077	CO 078	CO 079	CO 080	CO 081	CO 082	CO 083	CO 084	CO 085	CO 086	CO 087	CO 088	CO 089	CO 090	CO 091	CO 092	CO 093	CO 094	CO 095	CO 096	CO 097	CO 098	CO 099	CO 100
--------	----------	--------	--------	--------	--------	--------	--------	--------	--------	--------	--------	--------	--------	--------	--------	--------	--------	--------	--------	--------	--------	--------	--------	--------	--------	--------	--------	--------	--------	--------	--------	--------	--------	--------	--------	--------	--------	--------	--------	--------	--------	--------	--------	--------	--------	--------	--------	--------	--------	--------	--------	--------	--------	--------	--------	--------	--------	--------	--------	--------	--------	--------	--------	--------	--------	--------	--------	--------	--------	--------	--------	--------	--------	--------	--------	--------	--------	--------	--------	--------	--------	--------	--------	--------	--------	--------	--------	--------	--------	--------	--------	--------	--------	--------	--------	--------	--------	--------	--------	--------

T E N N E S S E E

600 000 m 800 000 m 1000 000 m 1200 000 m 1400 000 m 1600 000 m 1800 000 m 2000 000 m 2200 000 m 2400 000 m 2600 000 m 2800 000 m 3000 000 m

600 000 m 800 000 m 1000 000 m 1200 000 m 1400 000 m 1600 000 m 1800 000 m 2000 000 m 2200 000 m 2400 000 m 2600 000 m 2800 000 m 3000 000 m

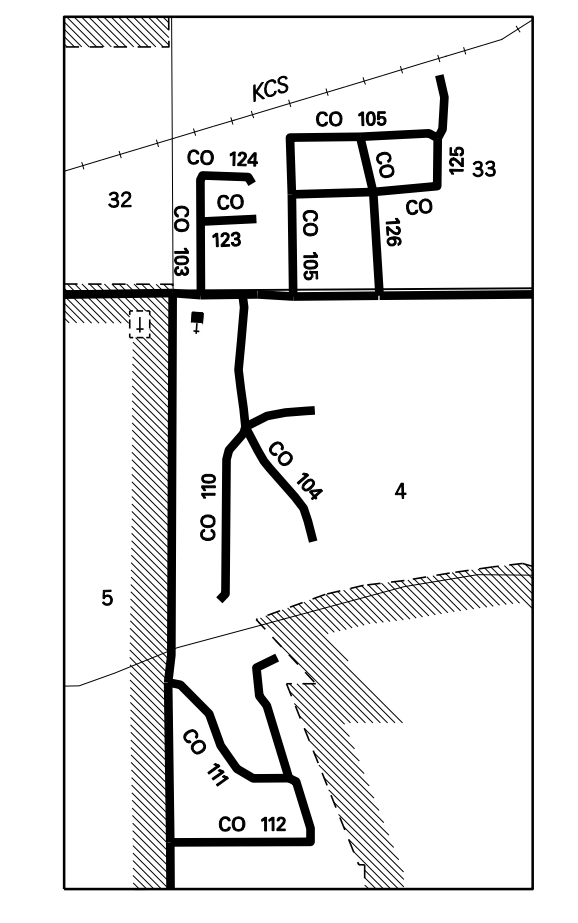
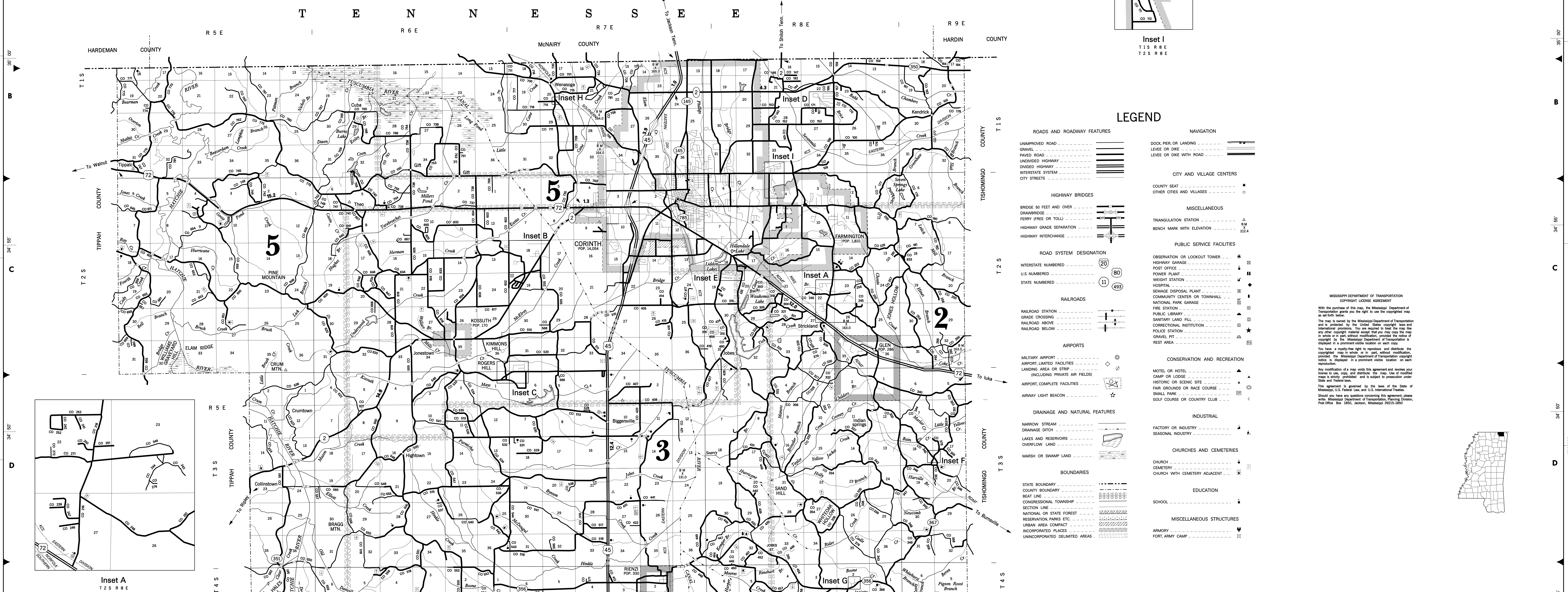

LEGEND

ROADS AND ROADWAY FEATURES	NAVIGATION
UNIMPROVED ROAD	DOCK PIER OR LANDING
GRAVEL	LEVEE OR DIKE
PAVED ROAD	LEVEE OR DIKE WITH ROAD
UNDIVIDED HIGHWAY	
DIVIDED HIGHWAY	
INTERSTATE SYSTEM	
CITY STREETS	
	CITY AND VILLAGE CENTERS
	COUNTY SEAT
	OTHER CITIES AND VILLAGES
	MISCELLANEOUS
	TRIANGULATION STATION
	BENCH MARK WITH ELEVATION
	PUBLIC SERVICE FACILITIES
	OBSERVATION OR LOOKOUT TOWER
	HIGHWAY GARAGE
	POST OFFICE
	POWER PLANT
	WEIGHT STATION
	HOSPITAL
	SEWAGE DISPOSAL PLANT
	COMMUNITY CENTER OR TOWNHALL
	NATIONAL PARK GARAGE
	FIRE STATION
	PUBLIC LIBRARY
	SANITARY LAND FILL
	CORRECTIONAL INSTITUTION
	POLICE STATION
	GRAVEL PIT
	REST AREA
	CONSERVATION AND RECREATION
	MOTEL OR HOTEL
	CAMP OR LODGE
	HISTORIC OR SCENIC SITE
	FAIR GROUNDS OR RACE COURSE
	SMALL PARK
	GOLF COURSE OR COUNTRY CLUB
	INDUSTRIAL
	FACTORY OR INDUSTRY
	SEASONAL INDUSTRY
	CHURCHES AND CEMETERIES
	CHURCH
	CEMETERY
	CHURCH WITH CEMETERY ADJACENT
	EDUCATION
	SCHOOL
	MISCELLANEOUS STRUCTURES
	ARMORY
	FORT ARMY CAMP

MISSISSIPPI DEPARTMENT OF TRANSPORTATION  
COPYRIGHT LICENSE AGREEMENT

With the purchase of this map, the Mississippi Department of Transportation grants you the right to use the copyrighted map as set forth below.

This map is owned by the Mississippi Department of Transportation and is protected by the United States copyright laws and international conventions. You are required to keep the map like any other copyrighted material about the map you use the map in whole or in part without modification, provided the notice of copyright by the Mississippi Department of Transportation is displayed in a prominent visible location on each copy.

You have a non-exclusive right to reproduce and distribute the copyrighted map in whole or in part, without modification, provided the Mississippi Department of Transportation copyright notice is displayed in a prominent visible location on each reproduction.

Any modification of a map voids this agreement and requires you license to the user, copy, and distribute. The map is modified maps is strictly prohibited and is subject to prosecution under State and Federal laws.

This agreement is governed by the laws of the State of Mississippi, U.S. Federal Law and U.S. International Treaties.

Should you have any questions concerning this agreement, please write: Mississippi Department of Transportation, Planning Division, Post Office Box 3850, Jackson, Mississippi 39215-2850

GENERAL HIGHWAY MAP  
**ALCORN COUNTY**  
MISSISSIPPI  
© 2010

MISSISSIPPI DEPARTMENT OF TRANSPORTATION  
PLANNING DIVISION  
IN COOPERATION WITH THE  
U.S. DEPARTMENT OF TRANSPORTATION  
FEDERAL HIGHWAY ADMINISTRATION  
TRANSVERSE MERCATOR PROJECTION,  
STATE PLANE COORDINATE SYSTEM 1983

DATA SOURCES

2006 ASCS AERIAL PHOTOS
1987 USGS DLG
1993 MDOT FIELD INVENTORY
2000 POPULATION 34,558
1993 BEAT LINES



300 000 m 310 000 m 320 000 m 330 000 m 340 000 m 350 000 m 360 000 m 370 000 m

88° 50' 1 88° 45' 2 88° 40' 3 88° 35' 4 88° 30' 5 88° 25' 6 88° 15' 7 88° 05'

ALCORN COUNTY MISSISSIPPI 2